



# Code Compliance Research Report CCRR-0100

Issue Date: 11-30-2016  
Renewal Date: 11-30-2017

Valued Quality. Delivered.

**DIVISION: 06 00 00 – WOOD, PLASTICS AND COMPOSITES**

**Section: 06 63 00 – Plastic Railings**

**MID ATLANTIC VINYL PRODUCTS, INC.**

5109 Commonwealth Drive

Fredericksburg, Virginia 22407

[www.mvpweatherwise.com](http://www.mvpweatherwise.com)

**REPORT SUBJECT:**

**WeatherWise® Vinyl Railing**

**Also known as NX-Rail® Vinyl Railing**

**Baltimore, Windsor, Fairfield, Brookfield,  
Kenmore, Charleston, Manchester, and Lexington  
Vinyl Guardrail Assemblies (Guards)**

## 1.0 SCOPE OF EVALUATION

1.1. This research report addresses compliance with the following Codes:

- 2012 International Building Code® (IBC)
- 2012 International Residential Code® (IRC)
- 2014 Florida Building Code (see Section 9) - Excluding High-Velocity Hurricane Zones

1.2. *WeatherWise®* Vinyl Railing has been evaluated for the following properties are guardrails or guards under the definitions of the referenced codes intended for use on elevated walking areas in buildings and walkways as required by the codes. Guard systems are provided as level guards for level walking areas such as decks, balconies and porches, and sloped guards for open sides of stairways.

## 2.0 STATEMENT OF COMPLIANCE

2.1. *WeatherWise®* Vinyl Railing complies with the Codes listed in Section 1.1, for the properties stated in Section 1.2 and uses stated in Section 1.3, when installed as described in this report, including the Conditions of Use stated in section 5.

## 3.0 DESCRIPTION

3.1. *WeatherWise®* Vinyl Railing are an assemblage of extruded and molded components utilizing white Poly

Vinyl Chloride (PVC) material with aluminum reinforcements and aluminum mounting brackets. All systems consist of the following components:

3.1.1. Top rails in the *Fairfield, Brookfield, Charleston,* and *Lexington* series are a "T"-Rail profile. See Figure 3.

3.1.2. Top rails in the *Baltimore, Windsor, Kenmore,* and *Manchester* series are a 2" wide by 3.5" tall rectangular profile with a wall thickness of 0.10". See Figure 4.

3.1.3. Bottom rails in all systems are a 2" wide by 3.5" tall rectangular profile. See Figure 4.

3.1.4. Balusters are 1.5" square and come in two styles, picket and spindle. Pickets are 1.5" square throughout its length. Spindles are 1.5" square at the ends and blow molded to form a turned spindle shape through the mid-section of the length. See Figures 1 and 2.

3.1.5. Level 42-Inch High Guards - The *Baltimore, Windsor, Fairfield,* and *Brookfield* series are intended to serve as 42-inch high guards up to 10-feet in length for use in all residential use groups. See Table 1.

3.1.5.1. An extruded aluminum insert provides reinforcement in the top and bottom rail. A secondary extruded aluminum insert is used in the top rail for guardrail lengths exceeding 8-feet. See Figure 5.

3.1.6. Level 36-Inch High Guards - The *Kenmore, Charleston, Manchester,* and *Lexington* series are intended to serve as 36-inch high guards up to 10-feet in length for use only in One- and Two-Family Dwellings. See Table 2.

3.1.6.1. An extruded aluminum insert provides reinforcement in the top rail and bottom rail. See Figures 6 and 7.

3.1.7. Stair 42-Inch High Guards - The *Baltimore, Windsor, Fairfield,* and *Brookfield* series have an overall assembly height of approximately 42 inches projected vertically from the nose of the stair tread and have a maximum rail length of 8-feet. See Table 1.



130 Derry Court • York, PA 17406

[www.intertek.com/building/](http://www.intertek.com/building/)



**3.1.8.** Stair 36-Inch High Guards - The *Kenmore*, *Charleston*, *Manchester*, and *Lexington* series have an overall assembly height of approximately 36 inches projected vertically from the nose of the stair tread and have a maximum rail length of 8-feet. See Table 2.

**3.1.9.** All components utilized in the stair rail assembly are the same as those utilized in the corresponding level rails with the exception of the baluster length.

**3.1.10.** Routed baluster holes in the PVC stair rail sections are elongated to 1.9" to allow the baluster to rotate corresponding to the slope of the stair.

**3.1.11.** Top and bottom rails are connected to posts using aluminum brackets secured to the posts with stainless steel wood screws. See Figures 8 and 9.

**3.1.12.** A nonstructural 4 inch square PVC post sleeve is provided for 4x4 conventional wood posts. Code compliance assessment of conventional wood posts is not within the scope of this report. See Section 6.0, Conditions of Use, for further conditions.

#### 4.0 PERFORMANCE CHARACTERISTICS

**4.1.** *WeatherWise*® Vinyl Railings have demonstrated their capacity to resist the design loads specified in Chapter 16 of the IBC and FBC when tested in accordance with ICC-ES AC174.

**4.2.** Structural performance has been demonstrated for a temperature range from -20°F to 125°F.

**4.3.** Materials used to produce *WeatherWise*® Vinyl Railings are deemed equivalent to preservative treated or naturally durable wood for resistance to weathering effects, decay, and attack from termites.

**4.4.** PVC materials used have a flame spread index less than 200 when tested in accordance with ASTM E 84.

#### 5.0 INSTALLATION

*WeatherWise*® Vinyl Railing must be installed in accordance with the manufacturer's published installation instructions, the applicable Code and this Research Report. A copy of the manufacturer's instructions must be available on the jobsite during installation.

**5.1.** Guardrail assemblies consist of top and bottom rails with pre-routed holes to receive balusters. Aluminum guardrail reinforcements are inserted in the

rails during assembly as specified for the series/model (see Section 3.0, Description).

**5.2.** Ends of stair rails must be field cut to provide a flush mount with the supports.

**5.3.** Aluminum brackets are secured to the support posts with three #12 by 1-1/4" flat head stainless steel screws and secured to the rails with two #8 by 3/4" flat head stainless steel screws.

#### 6.0 CONDITIONS OF USE

**6.1.** Installation must comply with this Research Report, the manufacturer's published installation instructions and the applicable Code. In the event of a conflict, this report governs.

**6.2.** Guards recognized in this report and regulated by the IBC or FBC are limited to exterior use in all construction types where wood is permitted in accordance with Section 1406.3 of the IBC and FBC and in One- and Two-Family Dwellings regulated by the IRC. 36-inch high guards are further limited to use in One- and Two-Family Dwellings (IRC and FBC-Residential).

**6.3.** Compatibility of fasteners, post mount brackets, and other metallic components with the supporting structure including chemically treated wood is not within the scope of this report.

**6.4.** Conventional 4x4 wood supports are outside the scope of this report and are subject to evaluation and approval by the building official.

**6.5.** Conventional 4x4 wood posts and structural support framing for post installations must satisfy the design load requirements specified in Chapter 16 of the building code and must provide suitable material for anchorage. Wood shall have a specific gravity of 0.50 or greater (Southern Yellow Pine or better). Where required by the building official, engineering calculations and details shall be provided.

**6.6.** Mid Atlantic Vinyl Products' *WeatherWise*® Vinyl Railing is manufactured in Fredericksburg, VA in accordance with the manufacturer's approved quality control system with inspections by Intertek-ATI (IAS AA-676).

#### 7.0 SUPPORTING EVIDENCE

**7.1.** Manufacturer's drawings and installation instructions.

**7.2.** Reports of testing and engineering analysis demonstrating compliance with the performance requirements of ICC-ES AC174, Acceptance Criteria for Deck Board Span Ratings and Guardrail Systems (Guards and Handrails), revised February 2014, and ASTM D 7032-07, Standard Specification for Establishing Performance Ratings for Wood-Plastic Composite Deck Boards and Guardrail Systems (Guards or Handrails).

**7.3.** ASTM D 7032-08 reviewed and deemed equivalent for compliance with 2012 IRC.

**7.4.** Quality control manual in accordance with ICC-ES AC10, Acceptance Criteria for Quality Documentation, dated June 2014.

## 8.0 IDENTIFICATION

*WeatherWise*<sup>®</sup> Vinyl Railing is identified with the manufacturer's name (Mid Atlantic Vinyl Products) address and telephone number, the product name (*WeatherWise*<sup>®</sup> Vinyl Railing), the phrase: "For Use in One- and Two-Family Dwellings Only" for the 36" guardrail systems, and the Intertek Mark as shown below, and the Code Compliance Research Report number (CCRR-0100).



## 9.0 OTHER CODES

### 9.1. Scope of Evaluation

*WeatherWise*<sup>®</sup> Vinyl Railing was evaluated for compliance with the 2014 Florida Building Code.

### 9.2. Conclusion

*WeatherWise*<sup>®</sup> Vinyl Railing, described in Sections 2.0 through 7.0 of this Research Report, comply with the 2014 Florida Building Code, subject to the following conditions:

- Use of *Weatherwise*<sup>®</sup> Vinyl Railing for compliance with the High-Velocity Hurricane Zone provisions of the 2014 *Florida Building Code* has not been evaluated, and is outside the scope of this Research Report.

## 10.0 CODE COMPLIANCE RESEARCH REPORT USE

**10.1.** Approval of building products and/or materials can only be granted by a building official having legal authority in the specific jurisdiction where approval is sought.

**10.2.** Code Compliance Research Reports shall not be used in any manner that implies an endorsement of the product by Intertek.

**10.3.** Reference to the Intertek website address: [whdirectory.intertek.com](http://whdirectory.intertek.com) is recommended to ascertain the current version and status of this report.

This Code Compliance Research Report ("Report") is for the exclusive use of Intertek's Client and is provided pursuant to the agreement between Intertek and its Client. Intertek's responsibility and liability are limited to the terms and conditions of the agreement. Intertek assumes no liability to any party, other than to the Client in accordance with the agreement, for any loss, expense or damage occasioned by the use of this Report. Only the Client is authorized to permit copying or distribution of this Report and then only in its entirety, and the Client shall not use the Report in a misleading manner. Client further agrees and understands that reliance upon the Report is limited to the representations made therein. The Report is not an endorsement or recommendation for use of the subject and/or product described herein. This Report is not the Intertek Listing Report covering the subject product and utilized for Intertek Certification and this Report does not represent authorization for the use of any Intertek certification marks. Any use of the Intertek name or one of its marks for the sale or advertisement of the tested material, product or service must first be approved in writing by Intertek.

**TABLE 1 – WEATHERWISE® VINYL RAILING IBC & FBC <sup>(1)</sup>**

Vinyl Railing System	Type	Maximum Guardrail Length <sup>(2)</sup>	Minimum Railing Heights <sup>(3)</sup>	Aluminum Rail Reinforcement	
				Top Rail	Bottom Rail
<i>Baltimore, Brookfield, Fairfield, &amp; Windsor</i>	Level	120"	42"	"Standard" H with secondary insert (Fig. 5)	"Standard" H (Fig. 5)
		96.375"	42"	"Standard" H (Fig. 5)	
	Stair	93.5"	42"	"Standard" H (Fig. 5)	

<sup>1</sup> All Use Groups

<sup>2</sup> Guardrail lengths are actual guardrail lengths, i.e. clear space between supports for level rails and sloping length of rail between supports for stair rails.

<sup>3</sup> Height is from the deck surface to the top of the top rail, which includes a 2 inch gap between the deck surface and the bottom of bottom rail.

**TABLE 2 – WEATHERWISE® VINYL RAILING IRC & FBC-RESIDENTIAL <sup>(1)</sup>**

Vinyl Railing System	Type	Maximum Guardrail Length <sup>(2)</sup>	Minimum Railing Heights <sup>(3)</sup>	Reinforcing Inserts	
				Top Rail	Bottom Rail
<i>Charleston, Kenmore, Lexington, &amp; Manchester</i>	Level	120"	36"	"Standard" H (Fig. 5)	"L" insert (Fig. 7)
		96.25"	36"	"Alternate" H (Fig. 6)	"L" insert (Fig. 7)
	Stair	93.75"	36"		

<sup>1</sup> Limited to exterior use as a guard system for balconies and porches for one- and two-family dwellings of Type V-B (IBC & FBC) construction and structures constructed in accordance with the IRC.

<sup>2</sup> Guardrail lengths are actual guardrail lengths, i.e. clear space between supports for level rails and sloping length of rail between supports for stair rails.

<sup>3</sup> Height is from the deck surface to the top of the top rail, which includes a 2 inch gap between the deck surface and the bottom of bottom rail.

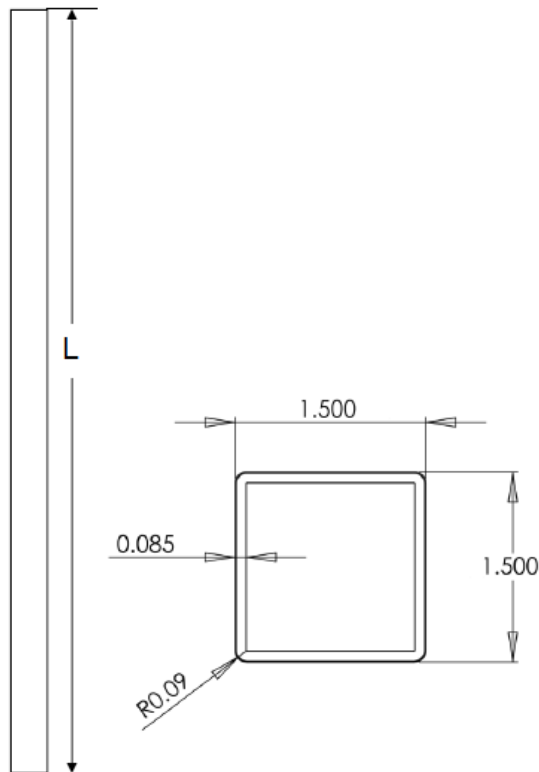

**FIGURE 1 – VINYL PICKET**

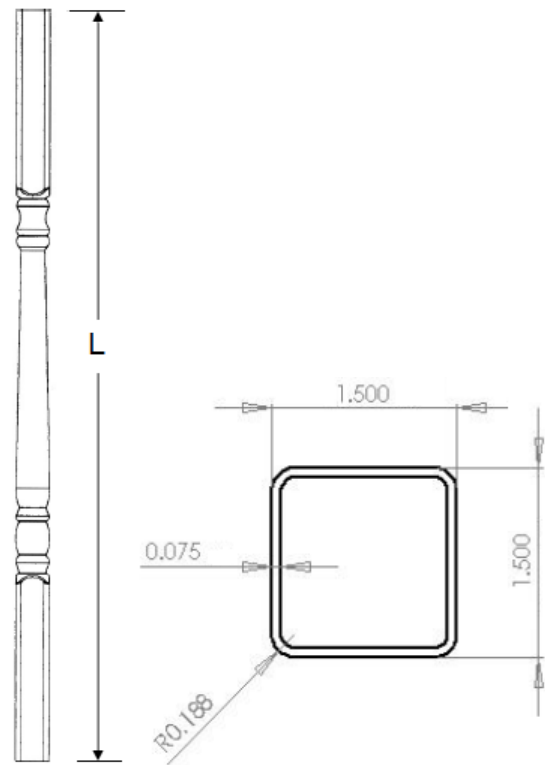

**FIGURE 2 – VINYL SPINDLE**

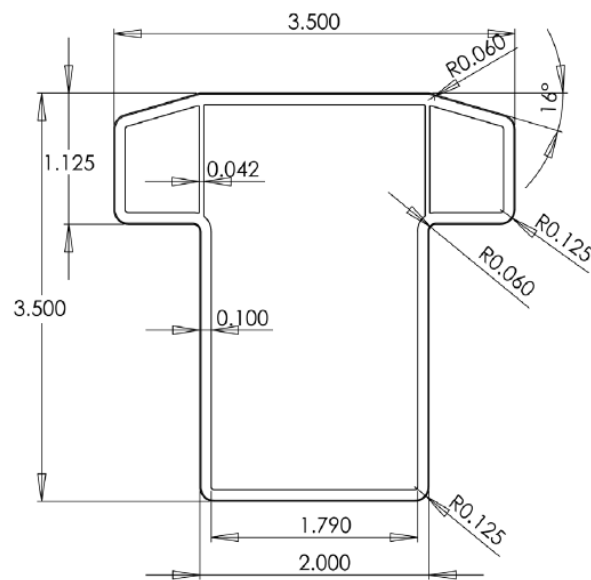

**FIGURE 3 – VINYL "T" RAIL**

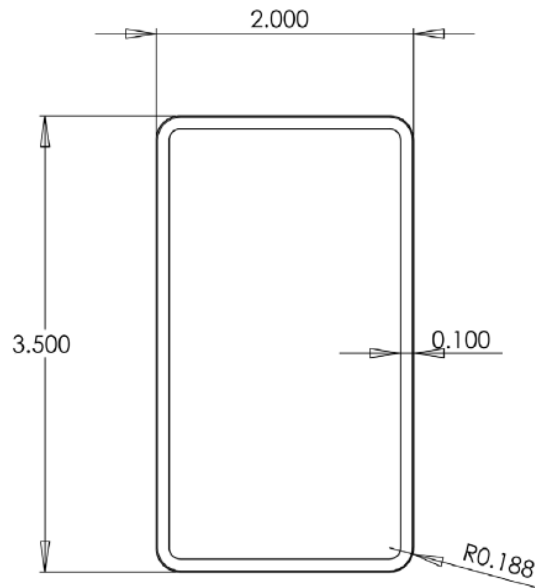

**FIGURE 4 – VINYL 2" X 3.5" RAIL**

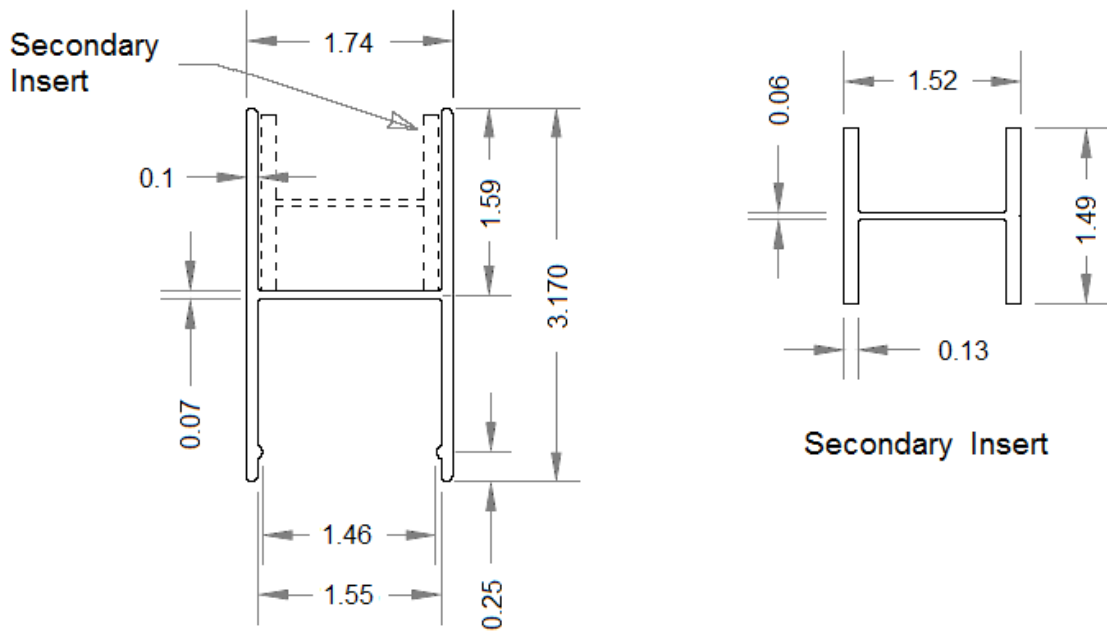

**FIGURE 5 – ALUMINUM "STANDARD" H INSERT WITH SECONDARY INSERT**

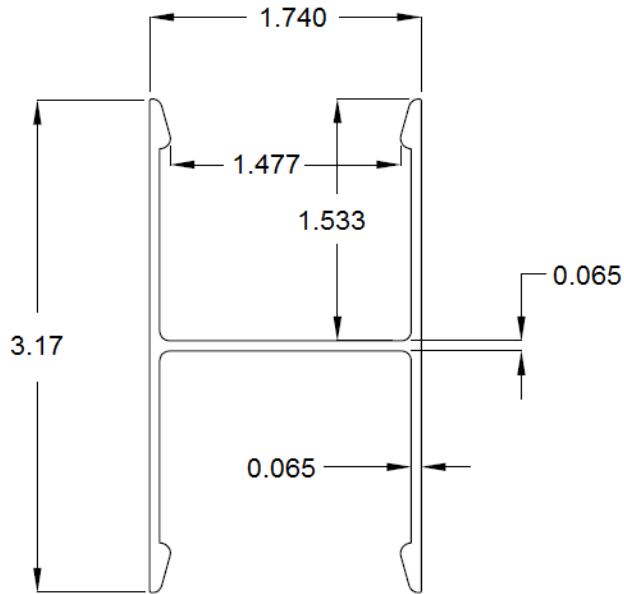

**FIGURE 6 – ALUMINUM “ALTERNATE” H INSERT**

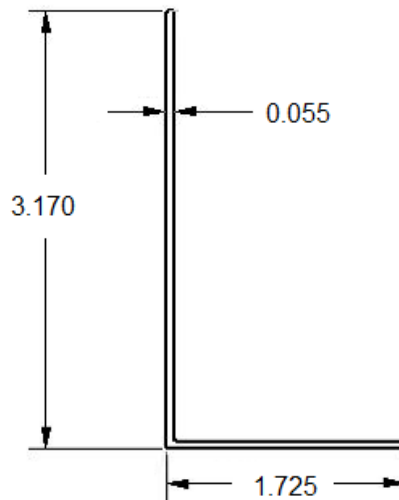

**FIGURE 7 – ALUMINUM “L” INSERT**

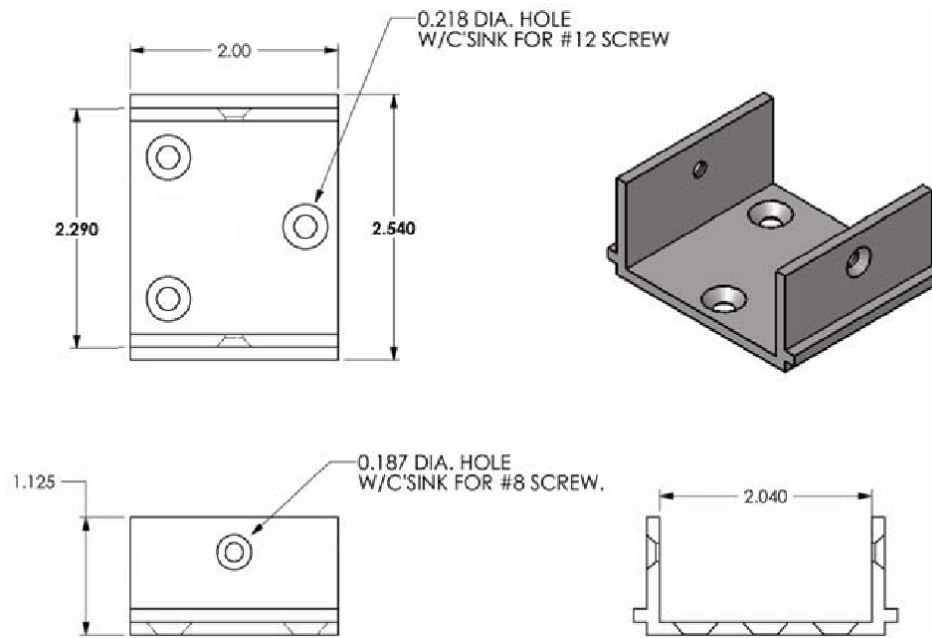

**FIGURE 8 – ALUMINUM LEVEL RAIL BRACKET**

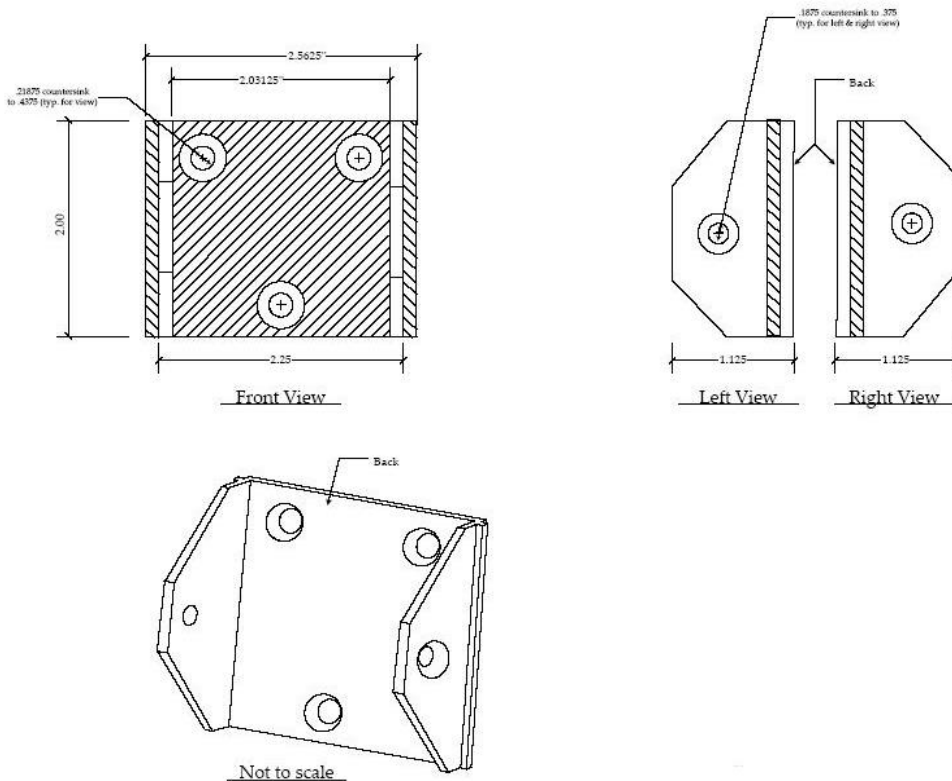

**FIGURE 9– ALUMINUM STAIR RAIL BRACKET**